

29 PEBBLE BEACH DR

Location 29 PEBBLE BEACH DR

Mblu 22/ 89/ / 29/

Acct#

Owner MACK JONATHAN E

Assessment \$575,100

PID 3494

Building Count 1

topoTopography

Utility Public Water, Public Sewer

Current Value

Assessment					
Valuation Year	Building	Extra Features	Outbuildings	Land	Total
2022	\$574,000	\$1,100	\$0	\$0	\$575,100

Owner of Record

Owner MACK JONATHAN E
Address 29 PEBBLE BEACH DR
BEDFORD, NH 03110

Sale Price \$465,000
Certificate
Book & Page 8904/2529
Sale Date 10/07/2016
Instrument 00

Ownership History

Ownership History						
Owner	Sale Price	Certificate	Book & Page	Instrument	Sale Date	
MACK JONATHAN E	\$465,000		8904/2529	00	10/07/2016	
WILLIAM & JEAN TALLMAN 2015 TRUST	\$2,666		8805/2008	1F	11/05/2015	
NORTHWESTERN MUT WEALTH &	\$4,000		8010/2438	1N	08/14/2008	
TALLMAN WILLIAM C & BANKBOSTON	\$4,000		6005/1341	1N	10/08/1998	
TALLMAN JEAN O	\$233,400		5626/1714	1N	05/16/1995	

Building Information

Building 1 : Section 1

Year Built: 1995
Living Area: 2,127
Replacement Cost: \$735,922

Building Percent Good: 78

Replacement Cost

Less Depreciation: \$574,000

Building Attributes	
Field	Description
Style:	Condominium
Model	Res Condo
Stories:	1 1/2 Stories
Grade	Good +30
Occupancy	1
Interior Wall 1:	Drywall/Sheet
Interior Wall 2:	
Interior Floor 1	Carpet
Interior Floor 2	
Heat Fuel:	Oil
Heat Type:	Forced Air-Duc
AC Type:	Central
Ttl Bedrms:	2 Bedrooms
Ttl Bathrms:	2 Full
Ttl Half Bths:	2
Xtra Fixtres	
Total Rooms:	6 Rooms
Bath Style:	Average
Kitchen Style:	Average
Kitchen Type	00
Kitchen Func	00
Primary Bldg Use	
Htwtr Type	00
Atypical	
Park Type	N
Park Own	N
Park Tandem	N
Fireplaces	
Num Part Bedrm	
Base Flr Pm	
Num Park	00
Pct Low Ceiling	
Unit Loen	
Grade	Good +30
Stories:	1
Residential Units:	149
Exterior Wall 1:	Cedar or Redwd

Building Photo



(https://images.vgsi.com/photos/BedfordNHPhotos/0000\36\98.jpg)

Building Layout

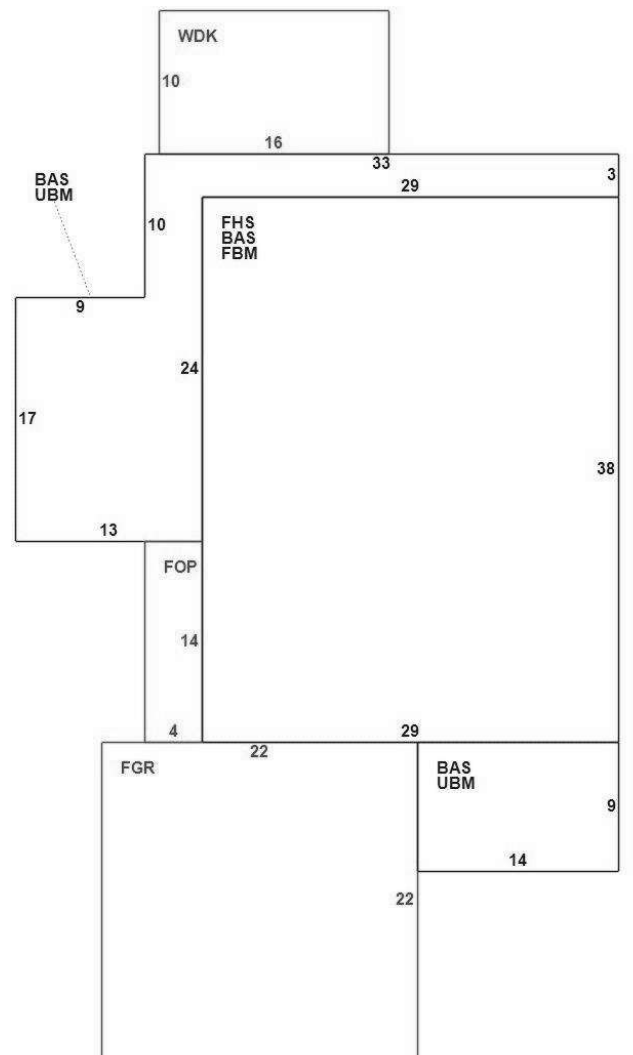

(ParcelSketch.ashx?pid=3494&bid=3557)

Building Sub-Areas (sq ft)			Legend
Code	Description	Gross Area	Living Area
BAS	First Floor	1,576	1,576
FHS	Half Story, Finished	1,102	551

Exterior Wall 2:	
Roof Structure	Gable/Hip
Roof Cover	Asph/F GlS/Cmp
Cmrcl Units:	0
Res/Com Units:	0
Section #:	0
Parking Spaces	0
Section Style:	0
Foundation	
Security:	
Cmplx Cnd	
Xtra Field 1:	
Remodel Ext:	
Super	
Grade	

FBM	Basement, Finished	1,102	0
FGR	Garage, Framed	484	0
FOP	Porch, Open	56	0
UBM	Basement, Unfinished	474	0
WDK	Deck, Wood	160	0
		4,954	2,127

Extra Features

Extra Features				<u>Legend</u>
Code	Description	Size	Value	Bldg #
FPL	FIREPLACE	1.00 UNITS	\$1,100	1

Land

Land Use

Use Code 1021
Description CONDO NL MDL-05
Zone AR
Neighborhood
Alt Land Appr No
Category

Land Line Valuation

Size (Acres) 0
Frontage 0
Depth 0
Assessed Value \$0

Outbuildings

Outbuildings		<u>Legend</u>
No Data for Outbuildings		

Valuation History

Assessment					
Valuation Year	Building	Extra Features	Outbuildings	Land	Total
2021	\$574,000	\$1,100	\$0	\$0	\$575,100
2020	\$455,600	\$1,100	\$0	\$0	\$456,700

2018	\$426,700	\$1,100	\$0	\$0	\$427,800
------	-----------	---------	-----	-----	-----------

(c) 2022 Vision Government Solutions, Inc. All rights reserved.